

Ultra Pure Sampling Valves

Not Just Going With The Flow!

The Aquasyn ARTeSYN™ engineered ultra pure sampling valve is not about giving you something the same as all the rest. It's about giving you a sample valve that's different but most importantly better!

After many years of careful consideration as to the evolving needs of the sampling of ultrapure and other high value fluids, the design staff had a breakthrough.

The result is what you see here in the illustrations and photographs of the product. A pitot style sample valve, with a continuous directed flush through the seal face and out through the connection pipework.

Easily customized to fit any sampling application, this concept has received positive responses from many who have struggled to maintain repeatability and accuracy of their samples. Sampling from the center of the process line eliminates many of the possible causes of contamination that are typical of other valve designs. You are certain to be certain with your ARTeSYN™ Pitot style sample valve.



The Aquasyn Difference

ARTeSYN™ stainless steel ultra-pure sampling valves are the ultimate means of mid-stream sample collection. High purity water applications that require the highest level of sample purity are going to enjoy the simplicity and effectiveness of this product. Sample zones near the center of the process line for greater representative accuracy. Flush patterns that ensure minimized dead zones near the sampling location. A more hygienic means of sampling has not been commercially developed.



Aquasyn California LLC

9525 Owensmouth Ave, Unit E, Chatsworth, CA 91311 Tel: 818 350 0423 Fax: 818 350 0424

Web: www.aquasyn.com

E-mail: sales@aquasyn.com



Ultra Pure Sampling Valves

Product Information

Dimensions:

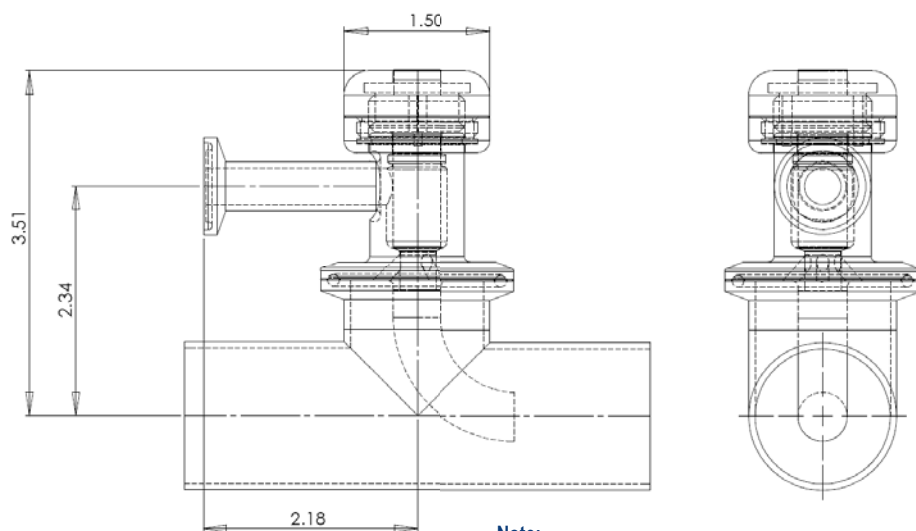

Note:

The Ultra Pure Sampling Valve Can Be Manufactured With or Without The Pitot Tube Pick-Up. Custom Inlet and Outlet Connections are available Upon Request.

How It Works:

Note:

The Ultra Pure Sampling Valve Can Be Orientated For Vertical And Horizontal Flow Patterns From Either Direction.

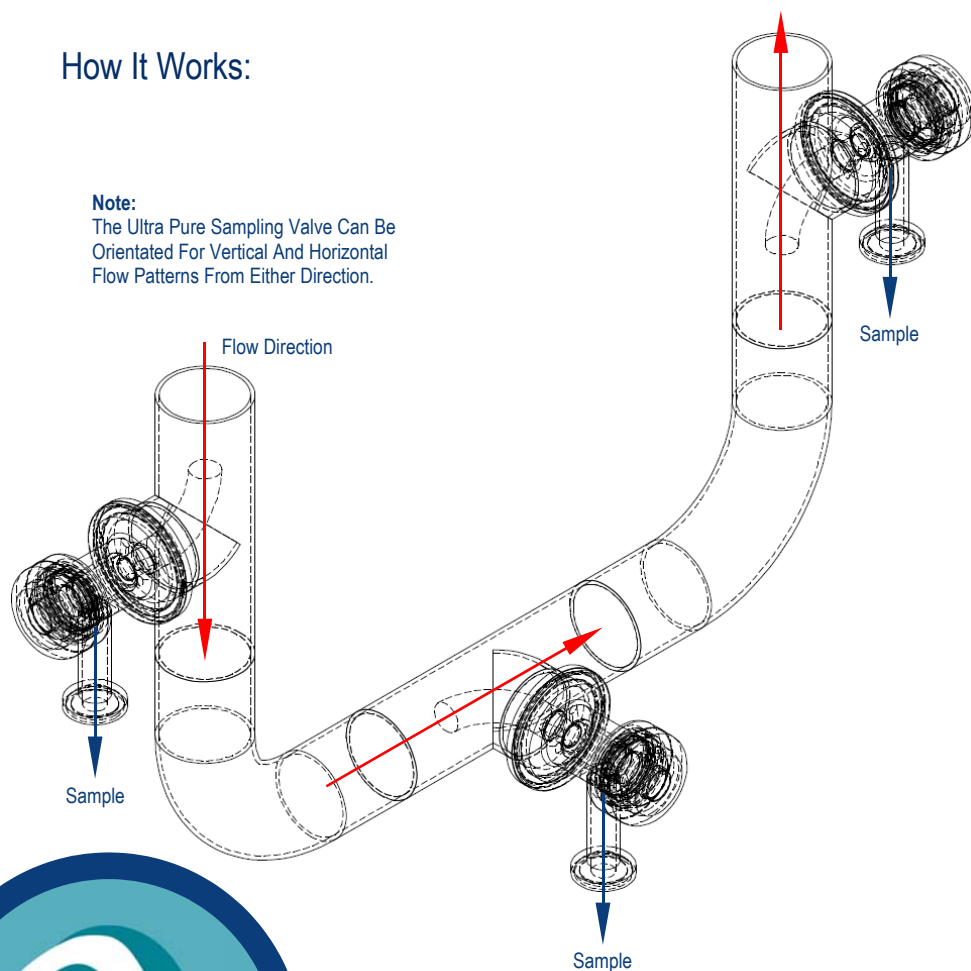

Features

Center flow Pitot Tube Sample Pick-Up.

Self Flushing Pitot Tube and Valve Seat.

Available in various materials of construction including Hastelloy¹ AL6XN² and Titanium.

Rising stem giving clear indication of Open/Close position.

Color coded handles for custom identifications.

Single piece non-rotating PVDF stem with integrated tip seal.

Minimal component parts, simplified construction

Multiple orientations and sizes available depending on flow patterns

No tools necessary for assembly and disassembly

Various end connections for ease of sample containment. Hygienic clamp, butt weld, orbital weld and special end connections available

All bodies are manufactured from BPE compliant bar stock with controlled sulfur (.005-.017%) ferrite<0.5%

Fully traceable bodies insure ease of validation/documentation

Surface finishes available from 25Ra to 10Ra, mechanical and electropolished



Aquasyn California LLC

9525 Owensmouth Ave, Unit E, Chatsworth, CA 91311 Tel: 818 350 0423 Fax: 818 350 0424

Web: www.aquasyn.com

E-mail: sales@aquasyn.com



Trademark of AlphaBio Inc.